

Standard Parts. **Ganter.**

Press Kit





Standard Parts. **Ganter.**

Press Kit

Contents	No.
Mounting clamps with high retaining power - GN 784	10.2016
Toggle clamp product range expanded	09.2016
For the perfect edge	08.2016
Securely clamped thanks to special tipped threaded studs - GN 306	07.2016
Hinges installed and adjusted quickly	06.2016
Individualized according to your needs - service standards	05.2016
Strainers stop particles - GN 7403	03.2016
Torque inside the handle - GN 3663	02.2016
Hooked, good and proper - GN 115.8	01.2016
Ganter - the secret champion from the Black Forest	

For further information visit:

www.ganter-griff.com

Standard Parts. Ganter.

Press Release 10.2016

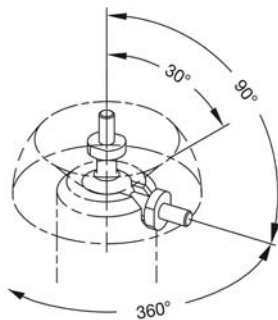

Mounting clamps with high retaining power

New to Ganter's product range: Mounting clamps with swivel ball joint for precise adjustments with high stop torque for low torque power as well as the option of customer-specific adaptations.

For some time Ganter has offered axial ball joints under standard GN 782 that are particularly suitable for smaller installation spaces. These joints can be mounted with a knurled union nut if a lower stop torque is required, while a higher stop torque can be achieved with an open ended wrench. Ganter has now introduced the GN 784 mounting clamp with swivel ball joint series for applications which require a higher stop torque while.

The new mounting clamp provides a larger rotating range of 360° around the vertical axis, thereby $\pm 90^\circ$ of the position predetermined by the swivel ball joint and $\pm 30^\circ$ of tilt angle in every position. The joint is therefore ideal for the adjustable assembly of cameras, lighting objects, air nozzles, monitors or scanners.

The swivel ball joint mounting is as easy as it is ingenious: a screw with a cone tip which is operated through an adjustable hand lever or with an internal hexagon moves the casing downwards and presses the ball into the pan-shaped base element. The high effectiveness of the clamping mechanism allows for high retaining powers to be achieved on the ball with a small tightening torque. In addition, the combination of the material surfaces between the ball and casing (aluminum, black – anodized) contributes to high friction within the fixed joint. For clamping with infrequent adjustment the hand lever can be omitted and the internal hexagon threaded stud option used instead. GN 784 mounting clamps come in four sizes, with the ball joint available in a tapped thread or threaded stud type version. Customer-specific swivel ball joint connections can be supplied economically even in comparatively small unit quantities.

The mounting clamp housing itself can either be attached from below via the female thread or via the GN 784.1 accessory flange, which enables assembly from above through three drill holes. An integrated tapered groove pin prevents the joint from rotating.

Find out more at www.ganter-griff.com

Ansprechpartner Contact

Axel Weber

Durchwahl direct extension

+ 49 (0) 7723 6507-226

E-Mail Email

axel.weber@ganter-griff.de

Otto Ganter GmbH & Co. KG

Normteilefabrik

Triberger Straße 3

78120 Furtwangen

Telefon +49 (0) 7723 6507-0

Telefax +49 (0) 7723 4659

www.ganter-griff.com

Standard Parts. Ganter.

Press Release
09.2016

Toggle clamp product range expanded

Latch-type toggle clamps, such as vertical and horizontal acting toggle clamps, have been a permanent feature of the Ganter product range for over 30 years. The expansion of both toggle clamp genres make them the ideal solution for an even wider range of applications.

Safety hooks keep the toggle clamp closed securely

GN 820.3 horizontal acting toggle clamps and GN 851.3 and GN 852.3 latch type toggle clamps provide a new function: an additional lock prevents inadvertent detachment caused, for example, by vibrations or incorrect operation. When the toggle clamp is closed, the additional safety hook automatically locks and holds the lever in a closed position. The spanner can then be opened, or rather, detached through a simple one-hand operation. The safety hook on the horizontal acting toggle clamps is operated by the index finger, while for the latch type toggle clamps it is opened by pressing from above with the thumb.

Now including spindle assembly with rubber tip

As previously, Ganter's horizontal and vertical acting toggle clamps leave no wish unfulfilled: we offer horizontal or vertical mounting bases, as an assembly kit or as a U-bar or solid bar versions. These components have long served as reliable standard parts. The possibility of including an adjustable spindle with a rubber tip is a new option. Until now, these had to be ordered separately as an accessory, for example as the GN 708.1 standard part. The spindle assemblies included in the set correspond to the standard sizes most commonly used – should a specific configuration be required, this can of course be ordered separately.

Along with the toggle clamp versions with additional locking as described above, spindle assemblies are also available for GN 810 (vertical acting toggle clamps), GN 812 (with dual flanged mounting base), GN 820 (horizontal acting toggle clamps), as well as for the GN 860 (pneumatically operated spanner) models.

Find out more at www.ganter-griff.com



Ansprechpartner Contact

Axel Weber

Durchwahl direct extension

+ 49 (0) 7723 6507-226

E-Mail Email

axel.weber@ganter-griff.de

Otto Ganter GmbH & Co. KG

Normteilefabrik

Triberger Straße 3

78120 Furtwangen

Telefon +49 (0) 7723 6507-0

Telefax +49 (0) 7723 4659

www.ganter-griff.com

Standard Parts. Ganter.

Press Release
08.2016

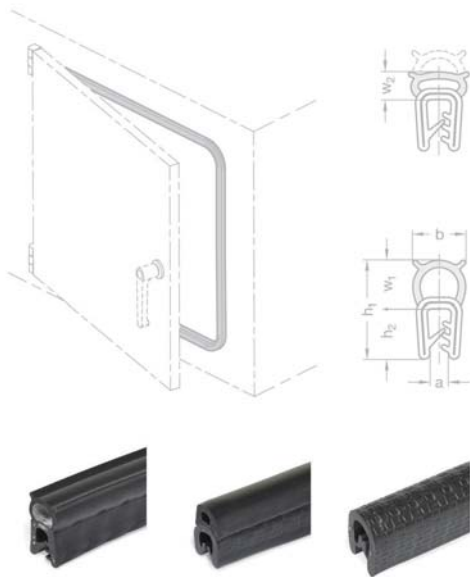

For the perfect edge

The highest quality: Ganter is introducing a range of edge protection profiles with and without sealing function.

Ganter is expanding its range of products once again. Edge protection profiles and edge protection seal profiles ensure secure front-side finishes on covers, cable ducts or openings, for example. Ganter are thereby offering everything that constitutes perfect sheet metal working from one source – even for smaller or occasional use. The edge protection profiles are delivered on rolls of 20 or 50 metres in length, without a minimum order value.

The edge protection profiles build not only an optically clean finish, they also protect surfaces from damage and prevent cables or tubes from being worn down in their encasing. In addition, they speed up the production phase as the burring or chamfering of edges is largely eliminated. GN 2184 is available in two sizes, is made of extruded PVC and can be assembled manually. The metal clamp insert prevents it from detaching.

The edge protection seal profiles GN 2180 and GN 2182 cater for edge protection and sealing in one. They are available in separate sizes and are made up of the clamping profile and the additionally extruded hollow chamber sealing profile with a softer finish. By applying the correct pressure, the profiles prevent dust, warm air or water spray from entering, while also reducing noise emissions. The clamp insert is made of a steel wire polyester combination, enabling a comparatively low minimum placement radius without the risk of an uneven profile fit or detachment. The seal profile is affixed to the top or the side of the clamping profile.

The profiles are available in a choice of EPDM or NBR, or in a combination of PVC and EPDM. NBR are particularly ideal for applications where contact with fuels or oils can occur. The consistently high-quality materials are permanently elastic and have good resilience, making their sealing properties particularly long lasting. All profiles fulfil the RoHS and Reach requirements. The EPDM profiles of GN2180 are additionally certified according to UL 50 and UL 94-HB, rendering exports to the US-American and Canadian market problem-free.

Find out more at www.ganter-griff.com

Ansprechpartner Contact

Axel Weber

Durchwahl direct extension

+ 49 (0) 7723 6507-226

E-Mail Email

axel.weber@ganter-griff.de

Otto Ganter GmbH & Co. KG

Normteilefabrik

Triberger Straße 3

78120 Furtwangen

Telefon +49 (0) 7723 6507-0

Telefax +49 (0) 7723 4659

www.ganter-griff.com

Standard Parts. Ganter.

Press Release
07.2016

Securely clamped thanks to special tipped threaded studs

Practically indispensable: Adjustable hand levers with levers that can be disengaged and rotated freely, are now also available with special tipped threaded studs for specific applications.

Adjustable hand levers made of zinc die cast, plastic or even stainless steel, are known for their diverse variations and many lever choices. Ganter's GN 300 and related series are available in countless options. Adjustable hand levers generally offer one significant advantage in comparison to their traditional counterparts, the fixed clamping lever: they can be disengaged once tightened and the lever can be swiveled to its optimal position. Ganter's hand levers are ideal operating elements for clamping in confined spaces and in predetermined lever positions.

Additionally, Ganter has now equipped its adjustable levers with optional tipped studs under the standard code GN 306, allowing the levers to be adapted ideally for their use. Tipped studs with brass or plastic tips (Types MS/KU) avoid damage to the area where the clamping force is applied to the component. Meanwhile, the hardened oval tip (Type DZ) has a clearly defined shape that provides a pressure point. Another available option is the stud with a spherical end (Type ZK), which can, for example, be used for alignment. The Type KD spherical end with swivel thrust pad distributes the pressure across a larger surface area.

All versions are available in three different thread sizes (M6, M8 and M10).

Find out more at www.ganter-griff.com

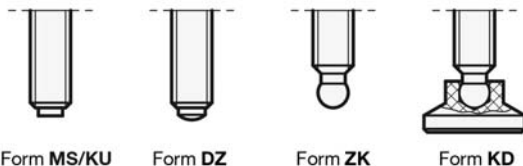

Form MS/KU

Form DZ

Form ZK

Form KD

Ansprechpartner Contact

Axel Weber

Durchwahl direct extension

+ 49 (0) 7723 6507-226

E-Mail Email

axel.weber@ganter-griff.de

Otto Ganter GmbH & Co. KG

Normteilefabrik

Triberger Straße 3

78120 Furtwangen

Telefon +49 (0) 7723 6507-0

Telefax +49 (0) 7723 4659

www.ganter-griff.com

Standard Parts. Ganter.

Press Release 06.2016

Hinges installed and adjusted quickly

Hinges are used to mount hatches and doors, and their installation and any resulting problems can be just as varied as the uses of the hinges themselves. In many cases Ganter offers quick solutions via additional components, to make the installation of hinges even easier and more effective for a particular application.

Spacer plates perform height adjustment

Gaps, differing door leaf thickness and sheet thickness or even sealants can cause the swing point contact of hinges between frames and doors to be positioned at different levels. Until now, these situations required the use of washers or rings made by uneconomical piece production. GN 2370 stainless steel spacer plates provide a solution. Dimensionally designed to work with the GN 237 and GN 337 families of hinges, they can be used individually or in combination to even out height differences. The spacer plates are available in four different thicknesses.

Plates with tapped holes replace nuts and washers

GN 2372 stainless steel plates with tapped holes, also designed for use with the GN 237 and GN 337 families of hinges, make the use of nuts and washers during installation unnecessary. Complex pre-assembly of discs and nuts and counter pressure to ensure tightening are eliminated. Instead, the plate with tapped holes attached to the top side of the hinge offers additional assembly opportunities such as the ability to mount on the back side of a panel or door (see application example).

Rubber bumpers mounted directly on the hinge

If a hinge requires a dampened stop and/or restricted rotation, then GN 2374 rubber bumper stops for hinges are recommended. The elastomer bumper is part of the component and requires no further mounting. Due to the stable cast steel frames of the rubber bumper stops, they can be installed directly with the hinges using countersunk screws, which save space. GN 2374 rubber bumper stops are used with lighter doors or in applications without dynamic loads.

Find out more at www.ganter-griff.com

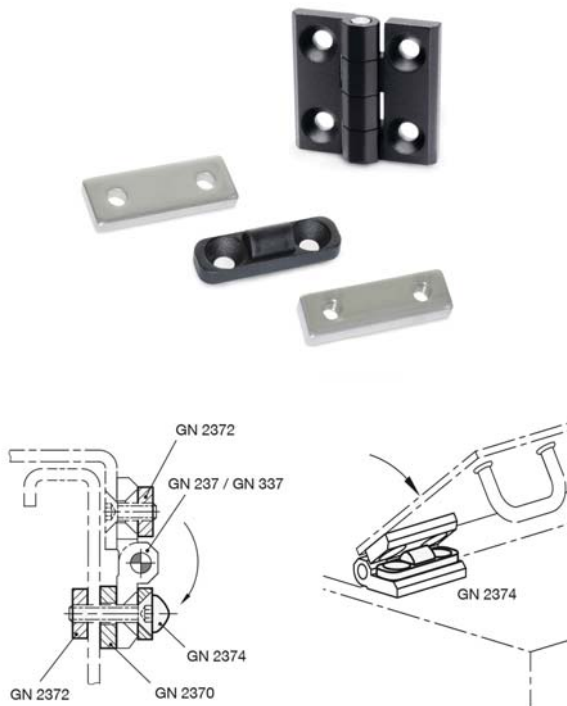

Ansprechpartner Contact

Axel Weber

Durchwahl direct extension

+ 49 (0) 7723 6507-226

E-Mail Email

axel.weber@ganter-griff.de

Otto Ganter GmbH & Co. KG

Normteilefabrik

Triberger Straße 3

78120 Furtwangen

Telefon +49 (0) 7723 6507-0

Telefax +49 (0) 7723 4659

www.ganter-griff.com

Standard Parts. Ganter.

Press Release
05.2016



Individualized according to your needs

Ganter is further on its way to increasingly customized standard machine elements. Our so-called „service standards“ save the customer time and money with options for machining and other modifications. Customer-specific modifications can simply be ordered in addition to the required component.

Oil dipsticks, with varying level markings and lengths, are just one example of this. Until recently, customer-specific modifications were up to customers themselves – now you can order precisely fitting dipsticks as a service. The newly-developed **GN 109 service standard** allows the customer to order pre-made oil dipsticks with individual markings and lengths – meaning they can be incorporated into the assembly process without any alterations.

Handwheels, cranks or shifting hubs are mounted in the radial or axial position by means of a cross pin or a set screw. As their positioning is highly specific, the operating components have no cross hole as standard. Before assembly, they must be made individually, which may cause relatively high costs. With the **service standard GN 110**, there is no need for this modification. Cross holes-one-sided, through holes, or with threads – are made at Ganter’s factory with precision and cost-effectiveness. A dimensional grid makes additional construction drawings unnecessary.

The **GN 110.1 service standard** also pertains to cross holes, relating however to universal joint shafts and universal joints. This standard defines the position of the cross holes / the cross thread with reference to the hub key slot / the square bore of the universal joints. It allows the quick and efficient machining of bore holes in the Ganter service center.

Handle components can now also be individually fitted with loss protection: for example, the **service standard GN 111.7** combines star knobs with key rings, ball chains or retaining cables. Ganter finishes the handle component with a suitable recess in which the key ring can be inserted permanently without removability.

Service standards allow Ganter to take on the time-consuming modification of standard machine components for the customer, without the need for intricate special equipment. In short: service standards offer you new benefits because they make the slogan „ready-to-use“ a reality.

Find out more at www.ganter-griff.com

Ansprechpartner Contact

Axel Weber

Durchwahl direct extension

+ 49 (0) 7723 6507-226

E-Mail Email

axel.weber@ganter-griff.de

Otto Ganter GmbH & Co. KG

Normteilefabrik

Triberger Straße 3

78120 Furtwangen

Telefon +49 (0) 7723 6507-0

Telefax +49 (0) 7723 4659

www.ganter-griff.com

Standard Parts. Ganter.

Press Release 03.2016



Strainers stop particles

Dirt particles should be blocked – or contained – when you ventilate enclosures or other air flow controlled devices. Ganter now has new stainless steel strainers with precise mesh sizes in the μm range.

The operation of machines and devices can generate pressure differences between the inside of the enclosure and its surroundings. This can be caused by temperature differences or by the dynamic movement of machine components. Paint stripping machines, for example, are protected from excessive stress by creating controlled pressure equilibrium.

In the past, machine designers attempted to achieve this goal by using a sintered structure or knitted wire fabric, approaches which did not allow permeability to be controlled with accuracy, therefore limiting the extent that dust and dirt were permitted to enter or exit.

Much more effective and, above all, much more precise are strainer-based pressure compensation components now offered by Ganter under the standard code GN 7403. The key feature is a stainless steel strainer embedded in polyamide with a precisely defined mesh size of 100 μm or 500 μm . Ganter strainers therefore provide an effective bidirectional barrier to stop dust, dirt particles or pollutants dispersed in the gas phase. Particles with diameters greater than the mesh size therefore can neither exit nor penetrate the device during pressure equilization.

The outside diameter of strainer components with recessed hexagon matches the bolt mounting holes for DIN 3852, and their thread length allows for different wall thicknesses.

Made from aluminum or stainless steel, each component has a sealing ring embedded in a radial and plane-sided recess which makes the seal captive, preventing it from being squeezed out during tightening. And for finished look, Ganter offers the additional solution of mounting nut GN 543.1.

Find out more at www.ganter-griff.com

Ansprechpartner Contact

Axel Weber

Durchwahl direct extension

+ 49 (0) 7723 6507-226

E-Mail Email

axel.weber@ganter-griff.de

Otto Ganter GmbH & Co. KG

Normteilefabrik

Triberger Straße 3

78120 Furtwangen

Telefon +49 (0) 7723 6507-0

Telefax +49 (0) 7723 4659

www.ganter-griff.com

Standard Parts. Ganter.

Press Release
02.2016



Torque inside the handle

To be protected from excess load or stress, torques for tightening clamping or thrust mechanisms must often be limited. Ganter has for these cases newly developed the GN 3663 torque limiting knob which combines easy and convenient handling and many customising options.

When designing their standard elements, Ganter has always been user-orientated and application optimised. One more recent example of this tight intermeshing with the requirements in practice is the new GN 3663 torque limiting knob. The name already hints at its special functionality: the handle is optionally fitted with an internal or external thread, but also with close-fit bore, and serves for quick clamping or for operating mechanical actuating elements. The integrated torque mechanism allows the manual torque transfer only up to a fixed torque maximum. Once this maximum is reached, the disk spring / engagement pin combination will “over-engage” and reliably prevent the non-permissible force transfer. In the opposite direction, the torque mechanism will lock, the undoing e.g. of a screw connection is therefore not subject to any force limitation and is possible at any time.

The standard element is available both with clockwise and anti-clockwise mechanism, with the diameters of the black oxidised knobs dimensioned to match the maximum torques which may be applied manually. Ganter offers standard torque ratings ranging from 0.7 to 5.5 Nm. Other customised torques can also be realised in smaller unit quantities. When mounting the close-fit bore variants, one special advantage is the fact that torque component and output side can be separated. This sophisticated modular concept allows virtually any output side solution.

This standard element, designed for fixed installation, requires no constructive changes when retrofitted and, compared with a torque tool, is a great deal more practical and cost-effective. Long-term tests with over 10,000 operations have shown that no significant wear and tear will occur and that the rated torque will not change.

Find out more at www.ganter-griff.com

Ansprechpartner Contact

Axel Weber

Durchwahl direct extension

+ 49 (0) 7723 6507-226

E-Mail Email

axel.weber@ganter-griff.de

Otto Ganter GmbH & Co. KG

Normteilefabrik

Triberger Straße 3

78120 Furtwangen

Telefon +49 (0) 7723 6507-0

Telefax +49 (0) 7723 4659

www.ganter-griff.com

Standard Parts. Ganter.

Press Release
01.2016



Hooked, good and proper

Ganter has for many years offered locking mechanism operating along the “latch-frame” prefriction principle.

But to keep a sliding door shut, you’ll need a different principle: the hook-type latch GN 115.8 acting in radial direction.

Not all doors, flaps or even manhole covers have frames which may be used as an abutment for locking mechanisms with clasp impeder. With hook-type latches, these locking challenges are no problem at all. Hook-type latches essentially consist of two elements, namely the fixed closing bolt and the hook including the rotating setup. The assembly locks in radial direction to the axis of rotation, the angle of rotation is normally 90 degrees to the left or right – depending on the installation of the hook and the associated stop pin. Without this pin, the hook can be turned by as much as 360 degrees.

As the hook features a catch bevel, mounting tolerances are no problem. The mechanism closes up to a side offset between axis of rotation and bolt of as much as 4 millimeters. Ganter’s hook-type latches also boast high vertical installation tolerances: the bolt rests in a longitudinal hole, allowing it to be adjusted by as much as 10 millimeters – which in turn delivers a perfect locking effect even with higher tolerances, without needing major refitting or adjustment work.

To operate the GN 115.8 hook-type latch, Ganter offers three options:

1. Lockable with cylinder lock and key, with and without additional operating handle.
2. Non-lockable, fitted with triangular, square, slot and VDE double bit drive with socket key.
3. The variant with star knob, wrench, knurled knob, lever or T-handle operated manually.

Casing and axes of the hook-type latch are made of die-cast zinc, the operating elements are made of plastic, all other parts are made of zinc-plated steel – all complying with RoHS, of course.

In all, the best possible hook-type locking mechanism can be found for virtually every specific requirement. And if not, Ganter will always find a non-standard solution.

Find out more at www.ganter-griff.com

Ansprechpartner Contact

Axel Weber

Durchwahl direct extension

+ 49 (0) 7723 6507-226

E-Mail Email

axel.weber@ganter-griff.de

Otto Ganter GmbH & Co. KG

Normteilefabrik

Triberger Straße 3

78120 Furtwangen

Telefon +49 (0) 7723 6507-0

Telefax +49 (0) 7723 4659

www.ganter-griff.com

Standard Parts. Ganter.

Press Release



Ansprechpartner Contact

Axel Weber

Durchwahl direct extension

+ 49 (0) 7723 6507-226

E-Mail Email

axel.weber@ganter-griff.de

Otto Ganter GmbH & Co. KG

Normteilefabrik

Triberger Straße 3

78120 Furtwangen

Telefon +49 (0) 7723 6507-0

Telefax +49 (0) 7723 4659

www.ganter-griff.com

Ganter - the secret champion from the Black Forest

With over 50,000 readily available products, Ganter is the Number One specialist in standard parts.

Handles, hinges, handwheels, clamp handles, knobs or clamping devices - all these are components which are needed virtually everywhere, in mechanical engineering as much as in laboratories, in plant equipment and in the transport sector. Components, many of which come from the Black Forest, directly off the high-rise shelves of the market leader: Otto Ganter GmbH & Co. KG.

Established in Furtwangen in 1894 as a small mechanical workshop, company founder Otto Ganter hit on the idea in 1912 to standardize operating elements - years before the German Industry Norm (DIN) came into being. An idea thriving and growing into a sustained model of success: today, the family-owned company in its fourth generation is present worldwide and keeps on growing. Over 300 people at the company's Black Forest headquarters permanently develop new elements, manufacture with ultimate precision and quality and ensure the fastest possible shipping. 85 percent of all orders leave our plant within 24 hours - a speed which sets standards. And with over 50,000 available variants, Ganter offers an unrivalled range and variety of standard parts.

What became known as the Ganter Standard after its launch 100 years ago eventually turned into an indispensable feature in many engineering and construction offices - and with it the Ganter catalogue, showing the entire range of products with all their characteristics on around 1,700 pages in the most recent 16th edition. The Ganter catalogue has long been a much sought-after manual which has successfully helped and accompanied generations of designers and developers. And - this being the digital age - all the data are also available online and can be loaded into all common CAD programs.

If, by any chance, there is a standard part that you need and cannot find in the extensive range of products, the people at Ganter will set to work to close the gap and develop a customized solution. This is also one part of the story which has made Ganter into what it is today: a successful player on the international stage.

Find out more at www.ganter-griff.com