

Positioning of the radial cross hole in relation to keyway / square

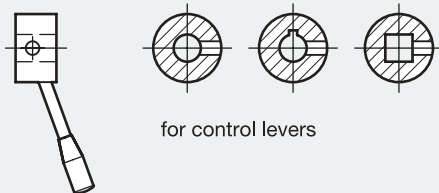

for control levers

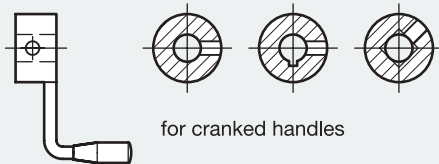
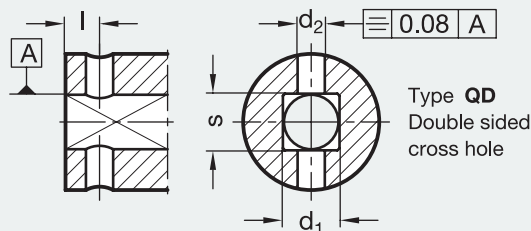

for cranked handles

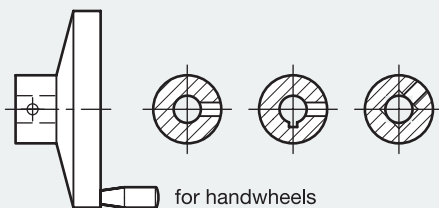
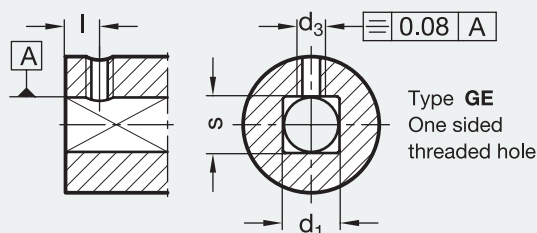

for handwheels

d <sub>1</sub> H7 / S H11		d <sub>2</sub> H11	d <sub>3</sub>	Length l – 0,1 Standard type	Length l – 0,1 for DIN 950 until Ø 250 only
6	7	2,5	M 3	4,5	–
8	9	3	M 5	5,5	4,5
10	11				
12	13	4	M 6	6,5	5,5
14	15	5	M 6	8	7
16	17	5	M 6	8	7
18	19	6	M 6	10	9
20	21	6	M 6	10	9
22	23				
24	25				
26	27				

### Information

The connection between the operating devices and the axle consists very often of a cross pin or a grub screw. As a result the user is faced with relatively high costs since cross holes on operating devices are in general not readily available.

Components with cross holes to GN 110 are not only offered at very competitive prices but they also save the manufacturer unnecessary drawing work. The geometrical form of some of the operating devices, however, does not lend itself to modification to this particular GN standard.

The radial positioning of the cross holes is only specified as per above three specifications of product groups (control levers, cranked handles, handwheels). For all other operating devices and the product group 2.7 it can be arranged any way.

The pin hole d<sub>2</sub> H11 is drilled to suit drive spring pins.

### How to order

**(Handwheel  
DIN 950-GG-160-B14-A)  
with cross hole  
GN 110-QE**

Code No. |  
Type