

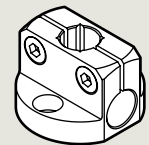

Adjustable clamping lever GN 511

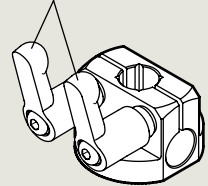

d1 Bore B for shaft tol. h11	b1	b2	d2	d3 Clamping thread	d4 for screw	l1	l2	l3	m	s Square V	Clamping lever for d3 
B 8	14	29	31,5	M 4	M 4	20	7	7	22	-	GN 511-M4-14
B 10	16	35	38	M 5	M 5	24	8	8	27	8	GN 511-M5-16
B 12	16	35	38	M 5	M 5	25	8	8	27	10	GN 511-M5-16
B 15	20	41	45	M 6	M 6	30	10	10	32	12	GN 511-M6-20
B 16	20	41	45	M 6	M 6	31	10	10	32	-	GN 511-M6-20
B 20	25	44	50	M 6	M 6	35	12,5	12,5	36	16	GN 511-M6-25

Specification

- ▶ Aluminium
matt **MT**
ground
anodized **ELS**
black
- ▶ Socket cap screws DIN 912
Stainless Steel
German Material No. 1.4301
- ▶ Adjustable clamping lever GN 511
Inserts / Distance bushings
Stainless Steel
German Material No. 1.4305
page 14

Information

The bore spacing m of the foot clamp mountings GN 473 is matched with the clamp mountings GN 477 and the flanged bolts GN 480.

The standard clamping bolts are socket cap screws DIN 912. They can be used in place of adjustable clamping levers GN 511 (see table of dimensions).

Clamp mountings GN 477 page 8

Flanged bolts GN 480 page 11

Retaining rods / tubings GN 480.1 page 12

How to order

Foot clamp mounting GN 473-B12-MT

Code No.		
	d1	Finish

Adjustable clamping levers GN 511 have to be ordered separately. They are supplied disassembled.