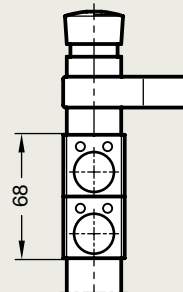
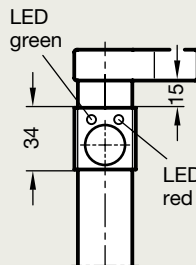
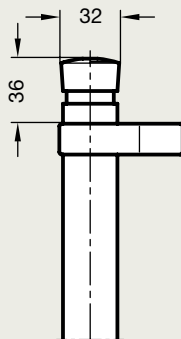
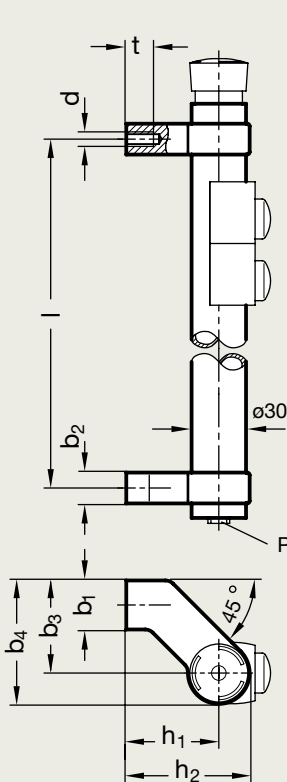

**Application example** (Door with right opening):

with emergency stop

with one button

 with emergency stop  
and 2 buttons

 Type **T0** without button  
 Type **T1** with 1 button  
 Type **T2** with 2 buttons

 Identification no. **1** without emergency stop  
 Identification no. **2** with emergency stop

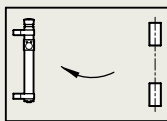
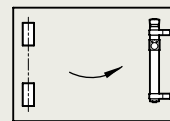
Plug M12x1, 12-pole

 Door opening  
left **L**

 Door opening  
right **R**

Length $l \pm 0,2$	d	b <sub>1</sub>	b <sub>2</sub>	b <sub>3</sub>	b <sub>4</sub>	h <sub>1</sub>	h <sub>2</sub>	t min.
200	M 8	27	17	51	68	51	68	15
300	M 8	27	17	51	68	51	68	15

**Specification**

- ▶ Tube  $\varnothing 30 \times 1,5$   
Aluminium

 Plastic coated  
black **SW** RAL 9005 textured finish

 anodized **EL** natural colour

- ▶ Handle shanks  
zinc die casting  
Plastic coated  
black **SW** RAL 9005 textured finish

- ▶ Cover caps plastic  
(for execution without  
emergency stop)  
light grey

**Information**

Tubular handles GN 332 (photo page 17) with power switching function are suitable for unlocking safety tumblers in rotating, detachable or side-sliding safety devices which must be closed in order to safeguard the required operational safety.

By integrating functions such as emergency stop, start, release, reset and LED status display, this tubular handle allows the machine to be monitored and operated directly at the door or gate.

Tubular handles GN 332 save mounting and installation work, are attractively designed and optimise ergonomics: the switching and operating functions are located precisely where they are needed.

*Tubular handles GN 331  
(with power switching function, straight) page 14*

*Tubular handles GN 333  
(without power switching function) page 100*

**How to order**
**Tubular handle**  
**GN 332-200-SW-T1-2-L**



Code no.	Length l	Finish	Type	Identification no.	Door opening
----------	----------	--------	------	--------------------	--------------

How to order the  
connection cable GN 330  
page 19

### Characteristics of the standard executions GN 332

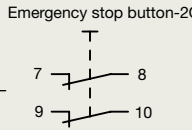
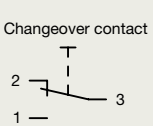
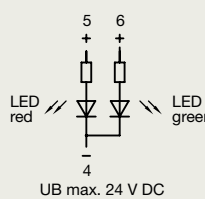
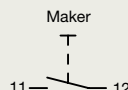
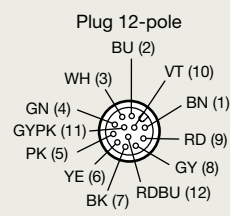
The tubular handles have the CE marking  
 low voltage guideline 06 / 95 / EG

Emergency stop:	2 channel		
1. Button: Release button:	Changeover contact		
2. Button: Start button:	Maker without LED		
Button colour:	for each button a set of caps is included, in this colours: red, green, blue		
Switching voltage:	max. 30 V AC max. 1,5 A		
Operating voltage (LEDs):	24 V DC ± 15%		
Contact termination:	M12x1, 12-pole		
Pin configuration:			
Protection class:	IP 67		
Connection cable:	Socket for plug connection M12x1, 12-pole		

- straight **G** 
- angled **W** 
- Lengths **5 meters**  
**10 meters**

### How to order

- Cable connection**  
GN 330-M12x1-12-G- 5  
G-10
- Cable connection**  
GN 330-M12x1-12-W- 5  
W-10

### Additional variations as special application

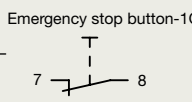
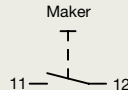
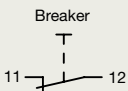
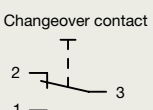
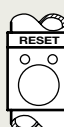
Emergency stop:	1 channel		
Number of buttons > 2 Button optional with	Maker		
	Breaker		
Button with labelling area			
Contact termination:	M12x1, 8-pole or M23x1, up to 12-pole		